



© Copyright by Meyle Products Gaertner GmbH



**MEYLE**<sup>®</sup>  
Products

***Metal/Rubber parts***

## ***INNOVATIVE QUALITY !***

### ***Metal/Rubber parts***

Since 1998 today's car manufacturers in their effort to increase the driving comfort have doubled the amount of parts used to reduce vibrations, harshness and noise.

Until the mid 80's the rigid rear axle was in part supported only by 6 generously dimensioned metal rubber bushings. In contrast today a multi-link independent rear axle is precisely steered by 22 weight optimised comfort bushings. MEYLE's analysis and statistics on today's car repairs prove that besides electronic defects the number of failures caused by metal/rubber parts is rising dramatically.

This is due to several reasons:

- increasing numbers of metal/rubber parts per car
- dimensioned for highest comfort and softer rubber
- weight optimised
- shorter development and testing time
- quality risks through global sourcing
- defective streets, not only in Germany

There are numerous examples of strut mounts, control arm bushings and silent blocks that fail after 25.000 miles. The replacement of these parts is costly and annoying if it is the same part again after another 20.000 miles.

MEYLE investigates failures and analysis the weakness of parts. MEYLE reengineers, strengthens and approves them to meet customers expectations. The pictures below show just one of MEYLE's improved parts.



**Gaps** filled with a higher grad of rubber and a larger bonding surface for more strength of the part

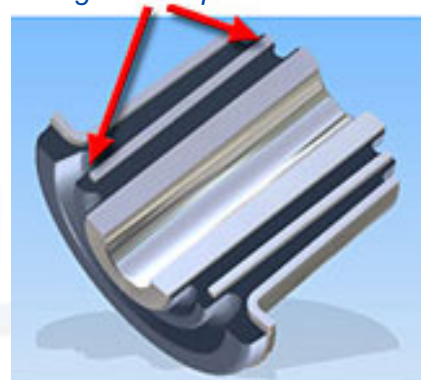

***MEYLE - Miles in Motion***