

Modell
Model **100 Quattro/100 Avant Quattro**
200 Quattro/200 Avant Quattro

Modelljahr
Modelyear **1985** → **1991**

Quality Made For The World

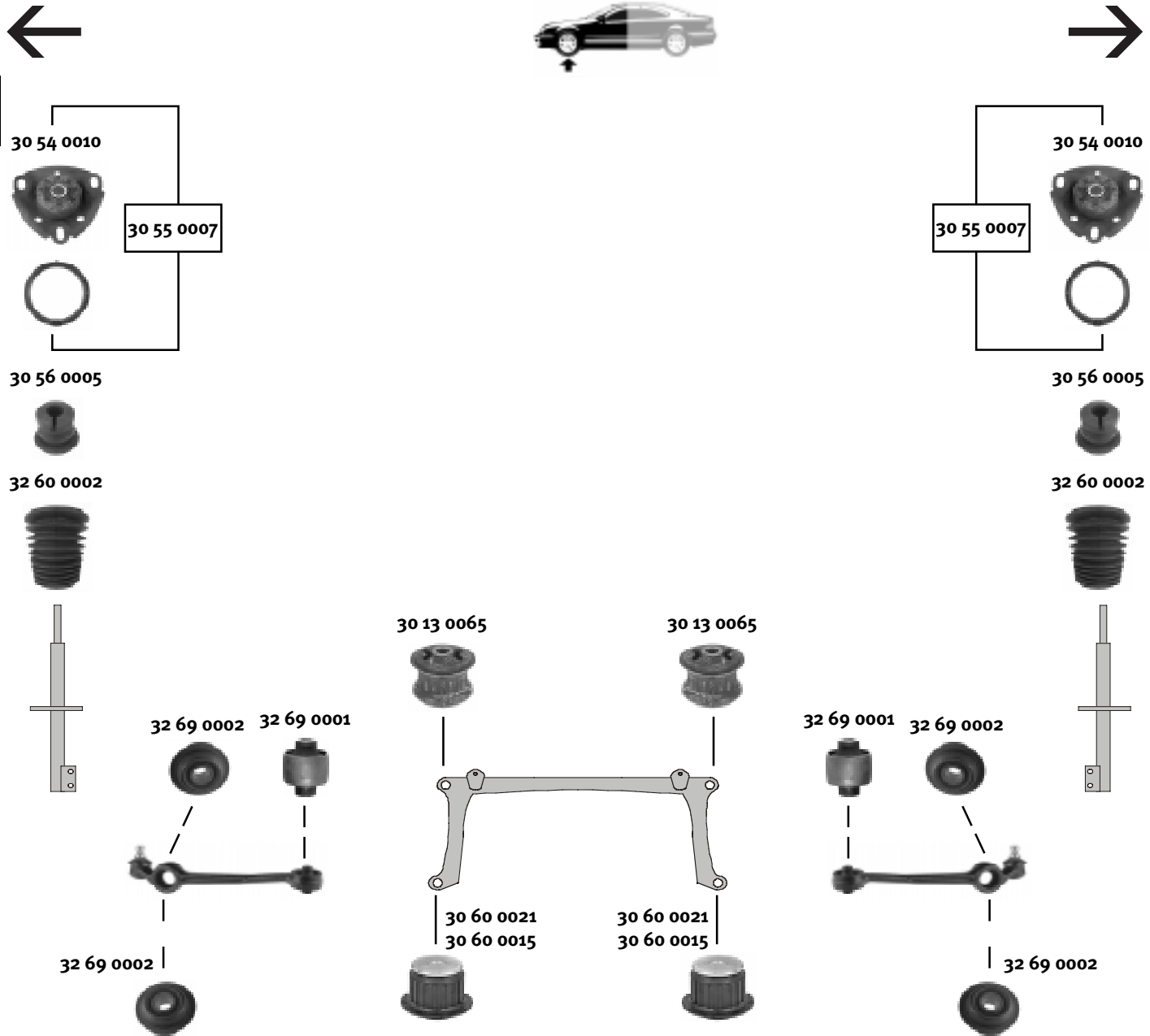

| | Ref.-N°. | | | |
|-------------------|---------------|---|---------------------|------------------|
| 30 55 0007 | 443 412 377 S | Rep. Satz Federbeinstützlager/rep. kit suspension strut mount | | |
| 32 69 0001 | 431 407 183 A | Querlenkerlager/control arm mount | | 12 x 46,5 x 58 |
| 30 60 0021 | 443 399 419 | Achskörperlager, Vorderachse/crossmember bush, front axle | 4 cyl. | 12 x 53 x 51 |
| 30 60 0015 | 443 399 419 A | Achskörperlager, Vorderachse/crossmember bush, front axle | 4 cyl. / 5 cyl. | 12 x 53 x 51 |
| 30 54 0010 | 443 412 377 | Federbeinstützlager/suspension strut mount | | |
| 30 56 0005 | 443 412 131 A | Anschlagpuffer, Stoßdämpfer/buffer, shock absorber | (ex.) 2.2/2.2 Turbo | |
| 30 13 0065 | 443 399 415 A | Achskörperlager, Vorderachse/crossmember bush, front axle | 4 cyl. / 5 cyl. | 12 x 46 x 51 |
| 32 60 0002 | 431 412 175 D | Faltenbalg, Stoßdämpfer/bellow, shock absorber | | |
| 32 69 0002 | 431 407 181 F | Stabilisatorlager/stabilizer mount | | 16,3 x 58,5 x 24 |

passend für/to fit

AUDI



Modell
Model **100 Quattro/100 Avant Quattro**
200 Quattro/200 Avant Quattro

Modelljahr
Modelyear
1985 ❖❖❖ **1991**

Quality Made For The World



30 54 0020

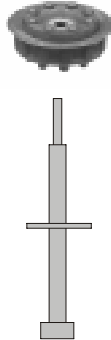

30 54 0020

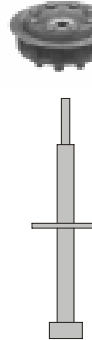

30 79 0019



30 79 0019

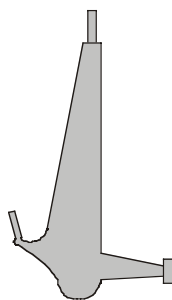





30 79 0019

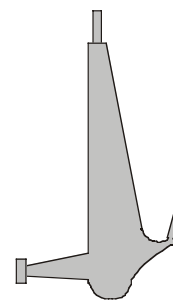

30 79 0019



|  | Ref.-N°. |  |  |  |
|---|---------------|---|---|---|
| 30 79 0019 | 443 511 247 D | Querlenkerlager/control arm mount | | 14 X 44 X 23 |
| 30 54 0020 | 443 512 331 | Federbeinstützlager/suspension strut mount | (ex.) N | Ø 10 H 40 |