

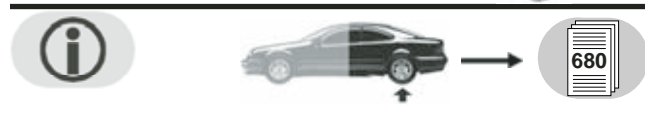

406 (1996 →)

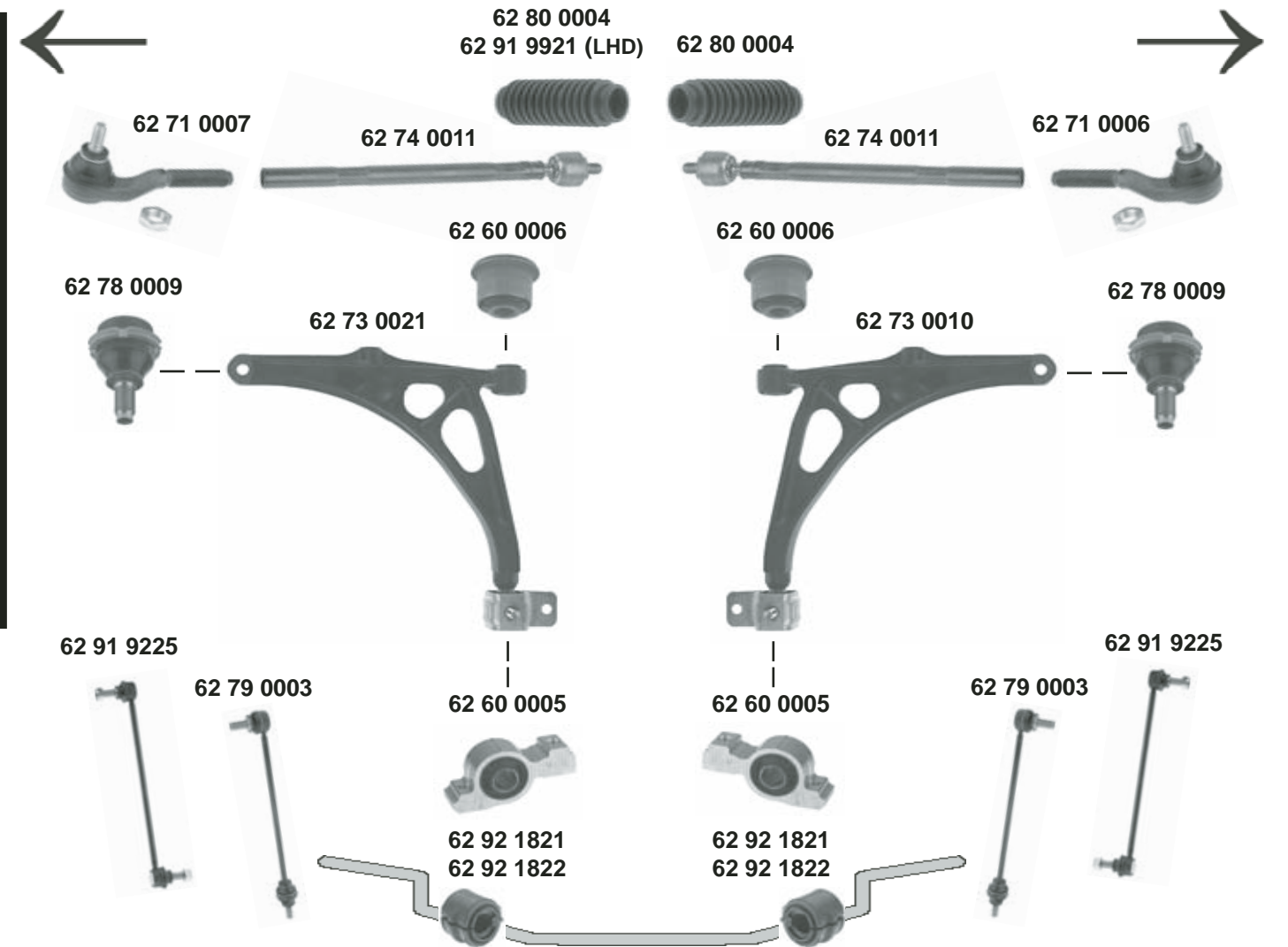

- (1) Bitte Abmessungen beachten / please not dimensions
 (1) (ex.) variable servo. : Bitte Abmessungen beachten / please not dimensions

	Ref. - No.			
62 60 0005	3523.61	Querlenkerlager / control arm mount		
62 60 0006	3523.60	Querlenkerlager / control arm mount		
62 71 0006	3817.39	Spurstangenendstück / tie rod end		M10x1,25
62 71 0007	3817.40	Spurstangenendstück / tie rod end		M10x1,25
62 73 0010	3521.80	Querlenker / control arm		
62 73 0021	3520.C0	Querlenker / control arm		
62 74 0011	3812.A9	Spurstange / tie rod	(1); (ex.) variable servo.	L 330
62 78 0009	3640.34	Traggelenk / ball joint		M14x1,5
62 79 0003	5087.40	Verbindungsstange / connecting rod	(ch.) → O 7664	
62 80 0004	4066.30	Lenkmanschette / steering boot	(1); (ex.) variable servo.	
62 91 9225	5087.48	Verbindungsstange / connecting rod	(ch.) O 7665→	
62 91 9383	3812.C4	Spurstange / tie rod	(2); variable servo.	
62 91 9921	4066.42	Lenkmanschette / steering boot	(1); (ex.) variable servo.	
62 92 1821	5094.74	Stabilisatorlager / stabilizer mount	für/to fit Stabi A 23	<input type="checkbox"/> I 23
62 92 1822	5094.75	Stabilisatorlager / stabilizer mount	für/to fit Stabi A 24	<input type="checkbox"/> I 24